

Assemble unit and sensor

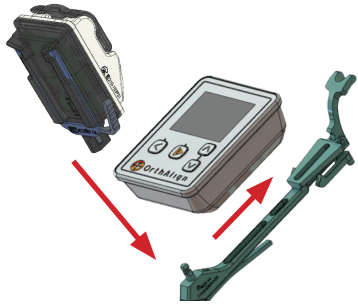

- Slide unit onto bracket
- Attach sensor to bracket post - line up arrows

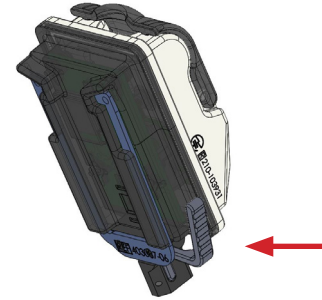

- Press lever to actuate sensor locking mechanism

Unit and sensor calibration

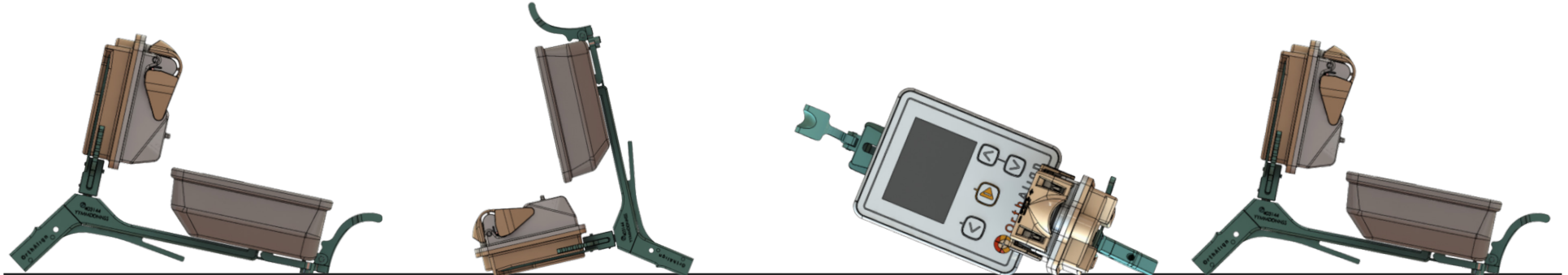

- Place unit on table and wait for beep
- Angle forward and wait for beep
- Place on left side and wait for beep
- Place unit on table and wait for beep

Probe calibration (For Supine Positioned Patients Only)

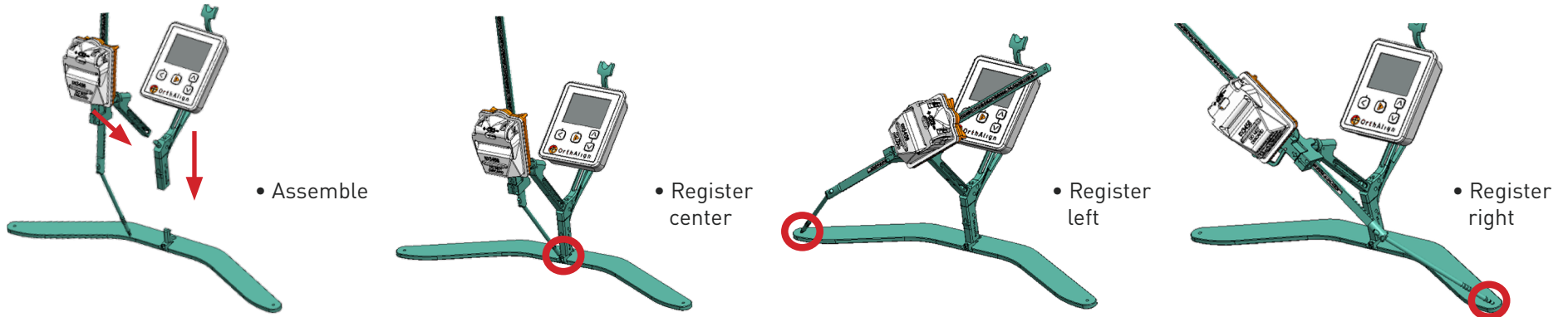

- Assemble

- Register center

- Register left

- Register right

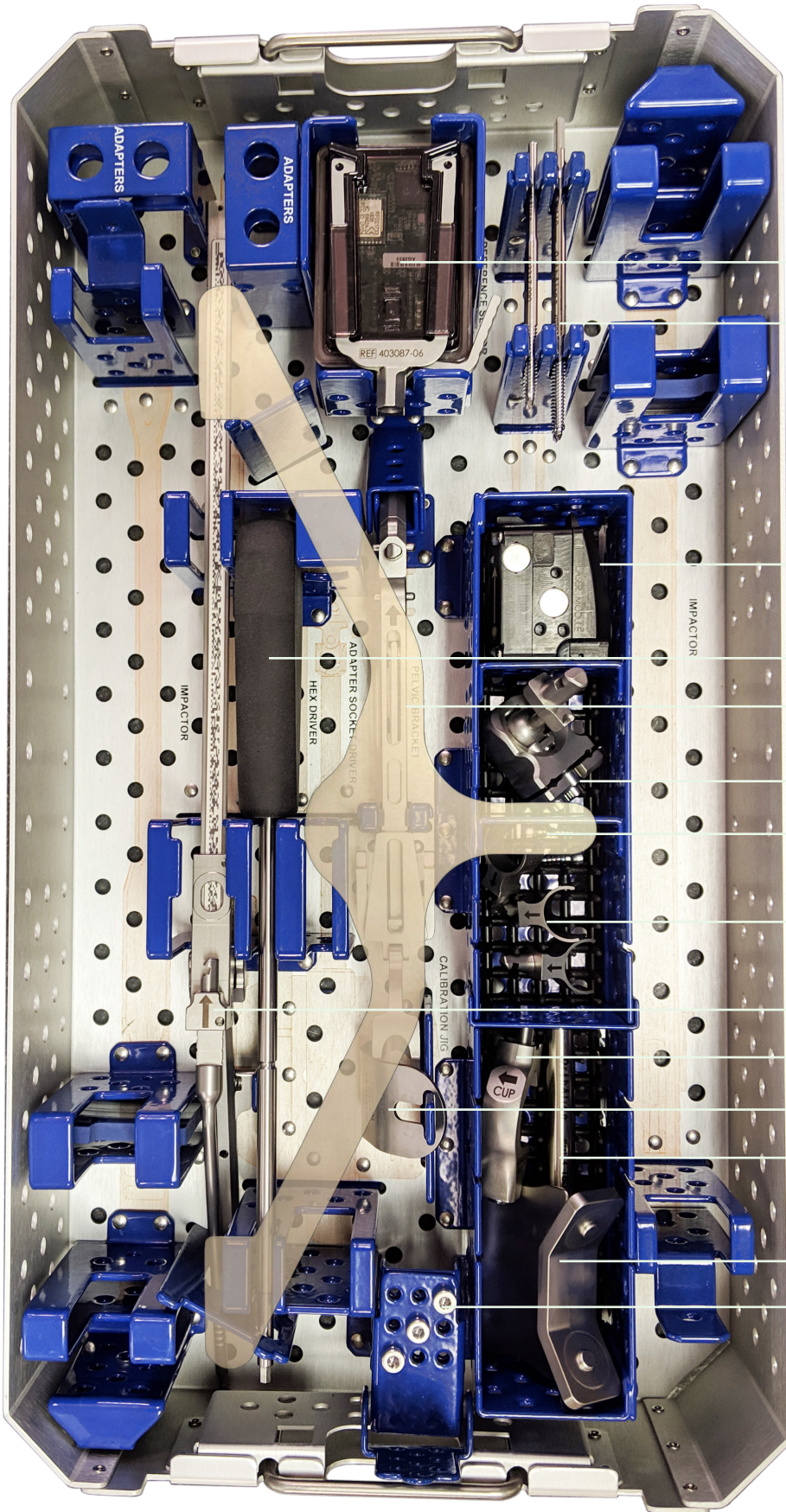

Reference Sensor

Threaded Fixation Pin

Laser Module

Hex Driver

Pelvic Bracket Assembly, Short
(Beneath Calibration Jig)

Pelvic Base

Probe Calibration Jig

Snap-on sensor post(s)

Registration Probe

Clamp-on sensor post(s)

Thigh Plate, Slotted

Holding Sleeve

Vertical Target, Magnetic

Femur Registration Tack

Refer to the Instructions for Use for details on cleaning and sterilization parameters.